

CC1 - 00

standard pressure gauge with steel casing

model	ø 40mm	ø 50mm	ø 63mm
BDT1 - 00/A with bottom connection		bottom	
BDT1 - 00/D with back connection		centre back	
standard features (stock items in bar)			
black case		painted steel	
bourdon tube system		brass	
window (push in)		plexiglas	
range in bar or equivalent		-1/0 ... 0/100	
thread bsp - npt - bspt	1/8"	1/4"	1/4"
max. process temperature		60 °C	
accuracy at 20 °C		1,6 %	
also available			
BDT1 - 05 (ø 40mm and ø 50mm)	case in brass		
BDT1 - 08 (all diameters)	case in stainless steel		



options	ø 40mm	ø 50mm	ø 63mm
back flange for wall mounting	n	n	BDT1 - 00/C
red pointer on dial	a	a	a
red pointer in plexiglas window	a	a	a
restrictor in connection	a	a	a
non standard thread	a	a	a
non standard dial	a	a	a

a = available as option; n = not available

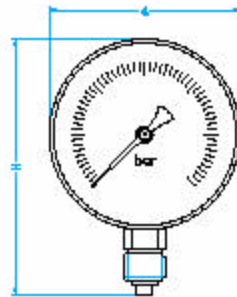

type A

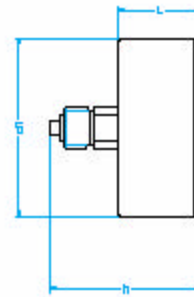

type D

measurements	ø 40mm	ø 50mm	ø 63mm
d in mm	40	50,5	63
d1 in mm	40	50,5	62
L in mm	25	28	28
H in mm	58	70	87
h in mm	41	49	51
weight in kg	0,06	0,10	0,14

dimensions are approximate and can be changed without prior notice